

VIEW A-A
SCALE 1 : 2

NOTE: MODEL AI-LM-2500-Z-MCB-7.5N SHOWN

STANDARD FEATURES

Stage	Z Stage
Travel	25+ mm
Motor	Ironless Core Linear Motor
Feedback	Non-Contact Optical Encoder
Scale	Gold Tape Scale Optional: Near Zero CTE ZeroMet
Resolution	1Vp-p Analog Output (5nm with 4096 Interpolation) Digital Output Options: 5um, 1um, 0.5um, 0.2um, 100nm, 50nm, 20nm**, 10nm**, and 5nm** (* Reduced Speeds Apply)
Sensors	Integrated Home and End of Travel Limits
Bearings	High Precision Crossed Roller Bearings
Counterbalance	Non-Contact Magnetic Spring (Constant Force)
Payload	0 to 1.5+ kg
Cables	High Flex, 10M Cycle, 3m Length
Structure	Anodized Aluminum 6061-T6 Optional: Stainless Steel
Environment	Standard Optional: Clean Room and Vacuum (10-6 Torr)
Temperature	0°C to 50°C
Humidity	10% to 80% Non-Condensing
Precision	6-D Nano Precision™ Test Methods

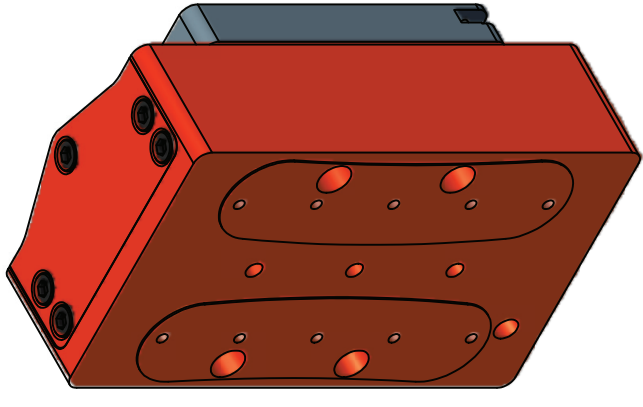

TRAVEL	MAX PAYLOAD (N)	DEPTH	WIDTH	HEIGHT	A	B	C	D	E	F	G	H	I	J
25	2.5 N, 7.5 N, or 15 N	56	88	144	75	37.5	98	23	25	50	65	51	M6	M4

* All units millimeters unless otherwise noted.
* All hole patterns centered on carriage or base footprint.
* See specifications sheet for allowable payload ranges.

ALIO INDUSTRIES PROPRIETARY INFORMATION
(Tel) 303.339.7500 - SALES@ALIOINDUSTRIES.COM - WWW.ALIOINDUSTRIES.COM



TITLE

**AI-LM-(TRAVEL)00-Z-MCB-
(MAX PAYLOAD)**

DRAWN	3/15/2013		
NBROWN			
CHECKED			
Tolerances: Surface Roughness: x.x ± .05 in [1.3 mm] x.xx ± .01 in [0.25 mm] x.xxx ± .005 in [0.13 mm] Angles ± 0.5°			
MATERIAL		DWG NO	REV
		0010-08033	001
FINISH	SCALE	ALIO STD TEMPLATE - REV 006	SHEET 1 OF 1
SEE NOTES	2		